

**ANNUAL RENTAL PAYMENTS FOR PLACEMENT OF ELECTRICITY  
COMPANY PLANT AND EQUIPMENT.  
EFFECTIVE FROM 1 APRIL 1997.**

STRUCTURE	RENT CODE	PAYMENT
Single Pole	11	£4.00
A or H pole	12	£4.50
Pole (1) & Stay		£5.00
A or H Pole & Stay		£5.50
Strut/Stay	13/14	£1.00
Additional Stay		£1.00
U/G Cable per 50 Metre Length	15	£1.15
Oversail per 100 Metre Length	16	£0.52

**ANNUAL COMPENSATION PAYMENT FOR INTERFERENCE WITH  
AGRICULTURAL OPERATIONS.**

ARABLE	CULTIVATED GRASS	HEDGE DITCH
--------	---------------------	----------------

STRUCTURE	CODE	PAY'T	CODE	PAY'T	CODE	PAY'T
Single Pole	17	£10.06	18	£1.77	75	£0.70
A or H Pole	19	£13.34	20	£2.98	76	£1.57
Pole (1) & Stay	21	£19.86	22	£3.86	77	£2.45
A or H Pole & Stay	23	£23.04	24	£5.07	78	£3.31
Strut/Stay	25	£9.80	26	£2.09	79	£1.73
Additional Stay	27	£4.84	28	£1.04	80	£0.86

Our reference:

Your reference:

Old Marston Parish Council  
31 Oxford Road  
Old Martson  
Oxford  
Oxon

  
**SOUTHERN  
ELECTRIC**

PO Box 151  
Yarnton  
Kidlington  
Oxon  
OX5 1BR  
Telephone: 01865 845825  
Facsimile: 01865 845851

8 June 2001

Dear Mr Garner

**Wayleave Payment Schedule.** *UNDERGROUND CABLE*

Please find attached a copy of our current payment schedule, this as requested.

The reference number for the consent in question is A 0037419 , with a current payment of £ 4.60 per annum.

Yours sincerely

  
Brian S Morgan  
Wayleave Officer / Surveyor

Examined with the original before Census  
noticed at the Office of John Edwards, Esq.,  
City Surveyor, Se. Malacca Street, Oxford.

G. G. B. White, Clerk of the Oxfordshire County Council, Oxford.

Form I.

# THE SOUTHERN ELECTRICITY BOARD.

21st September 1970

## Maplethorpe Consent.

ELECTRICITY (SUPPLY) ACTS, 1882—1936.  
ELECTRICITY ACT, 1947.

3/We, ..... The Mayor, Alderman and Citizens of Oxford .....

of ..... By the Hand of Harry Plooman Their Town Clerk .....

being the owner(s) and occupier(s) of land situate in the Parish of ..... Old Marston .....

..... in the County of ..... Oxford .....

(hereinafter referred to as "the land") shown on the plan annexed hereto and thereon coloured pink for myself/ourselves my/our successors and assigns HEREBY CONSENT to The Southern Electricity Board (hereinafter referred to as "the Board") placing on or under the land the works described in the First Schedule hereto in the position (as near as may be) indicated in ..... Red .....

on the plan and using maintaining repairing replacing altering renewing inspecting and removing the same and to the Board cutting lopping or felling in a woodman-like manner any tree or hedge on the land which obstructs or interferes with the said works and to the Board entering on the land at all reasonable times by themselves their servants and agents for any of the purposes aforesaid upon the following terms:—

1. The Board shall pay to me/us during the existence of the works on the land by way of rent and compensation for interference with cultivation yearly sums calculated in accordance with the Second and Third Schedules hereto it being understood that the payment calculated in accordance with the Third Schedule hereto will be passed on by me/us to the person in occupation of the land at the date hereof so long as such occupation continues.

2. In addition to any compensation payable under Condition 1 hereof the Board shall

(a) make good or compensate me/us for any injury suffered by me/us or damage done to the surface of the land or to my/our property thereon and

(b) indemnify me/us against any action or claim which may be brought or made against me/us or made against me/us attributable to or arising out of anything done by virtue of this consent and not occasioned by my/our negligence or the negligence of my/our servants or agents PROVIDED THAT I/we shall as soon as practicable give notice of any such injury or damage suffered by me/us or any such action or claim brought made or threatened against me/us and shall not settle adjust compromise or defend such action or claim without the consent of the Board PROVIDED FURTHER that the Board may take over the conduct of any such action or claim in my/our name and I/we shall give such information and assistance as the Board may reasonably require.

3. This Consent shall remain in force until determined by either party giving to the other party at any time twelve months' previous notice in writing in that behalf subject to the rights of the Board under section 11 of the Electricity (Supply) Act, 1922.



FIRST SCHEDULE.  
DESCRIPTION OF WORKS.

Underground High Tension Cable

SECOND SCHEDULE.  
RENT.

For each single pole, strut or stay ... .. per annum.  
For each "A" or "H" pole ... .. 1/-  
For any electric line laid underground each 100 yards length or  
part thereof ... .. 1/6  
Payable on the.....in each year the first payment  
to be proportioned from the date of commencing the placing of the works.

THIRD SCHEDULE.  
COMPENSATION FOR INTERFERENCE WITH CULTIVATION.

	Erected on	Cultivated
	Arable land	grass land
	per annum	per annum
Each single pole, strut or stay ... ..	5/-	2/6
Each "A" or "H" pole ... ..	7/6	3/9

Payable on the .....in each year the first payment  
to be apportioned from the date of commencing the placing of the works.

DATED this.....21st..... day of .....November.....19.55...

SIGNED by the said

.....Harry PLOWMAN.....  
.....Harry PLOWMAN.....  
in the presence of :—

Name of A. ARNETT  
Witness.....  
Address.....Tomn. Clerk's Office.....  
.....Oxford.....  
Occupation.....Clerk.....

All communications concerning this consent should be addressed to :—

*The District Manager,*  
*The Southern Electricity Board,*

.....37, George Street.....  
.....Oxford.....

Form No. W.15.  
On behalf of the Southern Electricity Board, I agree to the conditions  
attached to this Consent dated this Twenty First day of November, 1955  
District Manager.



Marston

Cannon's Farm

Court Place Farm

152  
7-281

T

Boul's Farm

HARRY PLOWMAN  
TOWN GREEN

PROPOSED UNDERGROUND CABLE

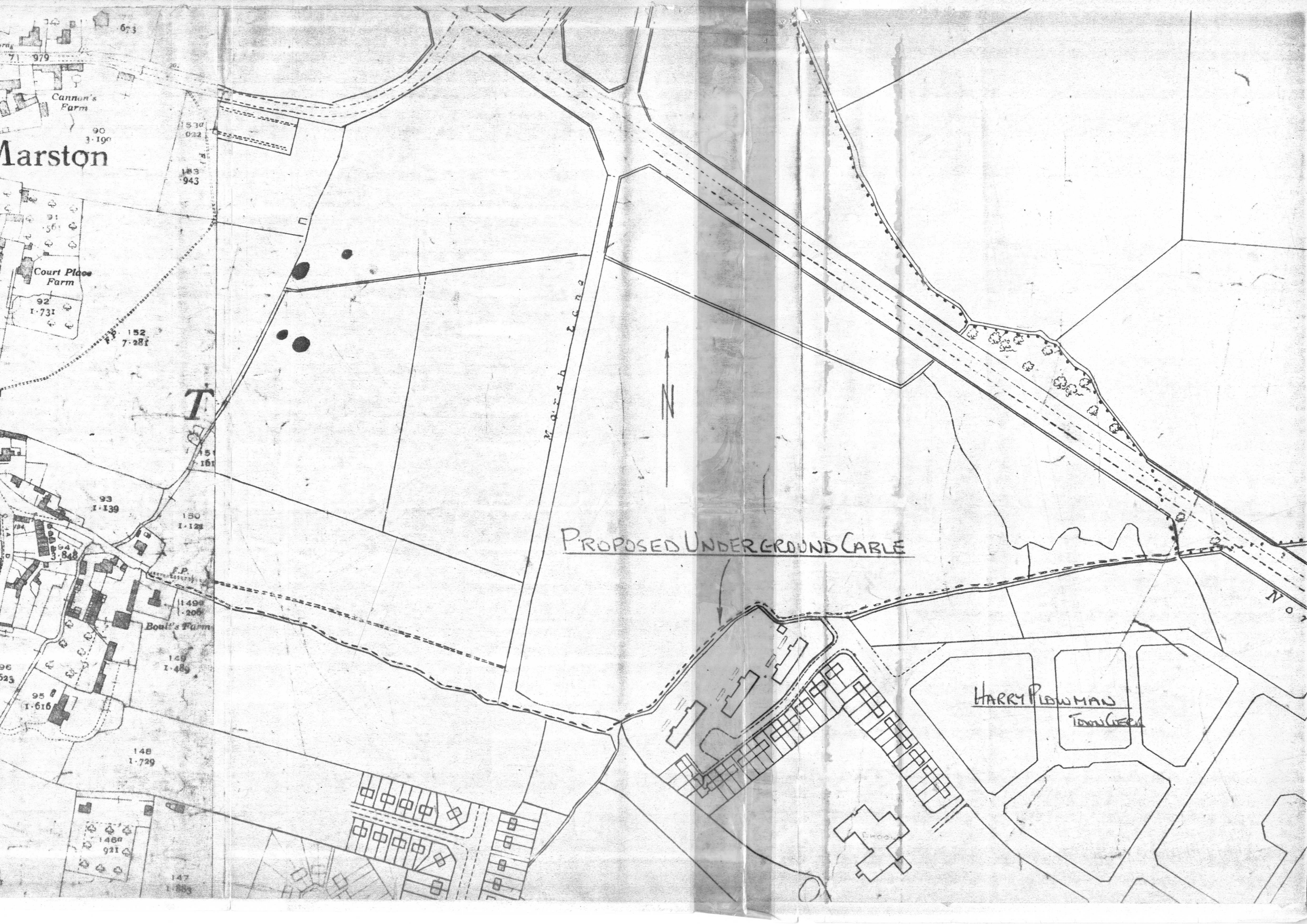



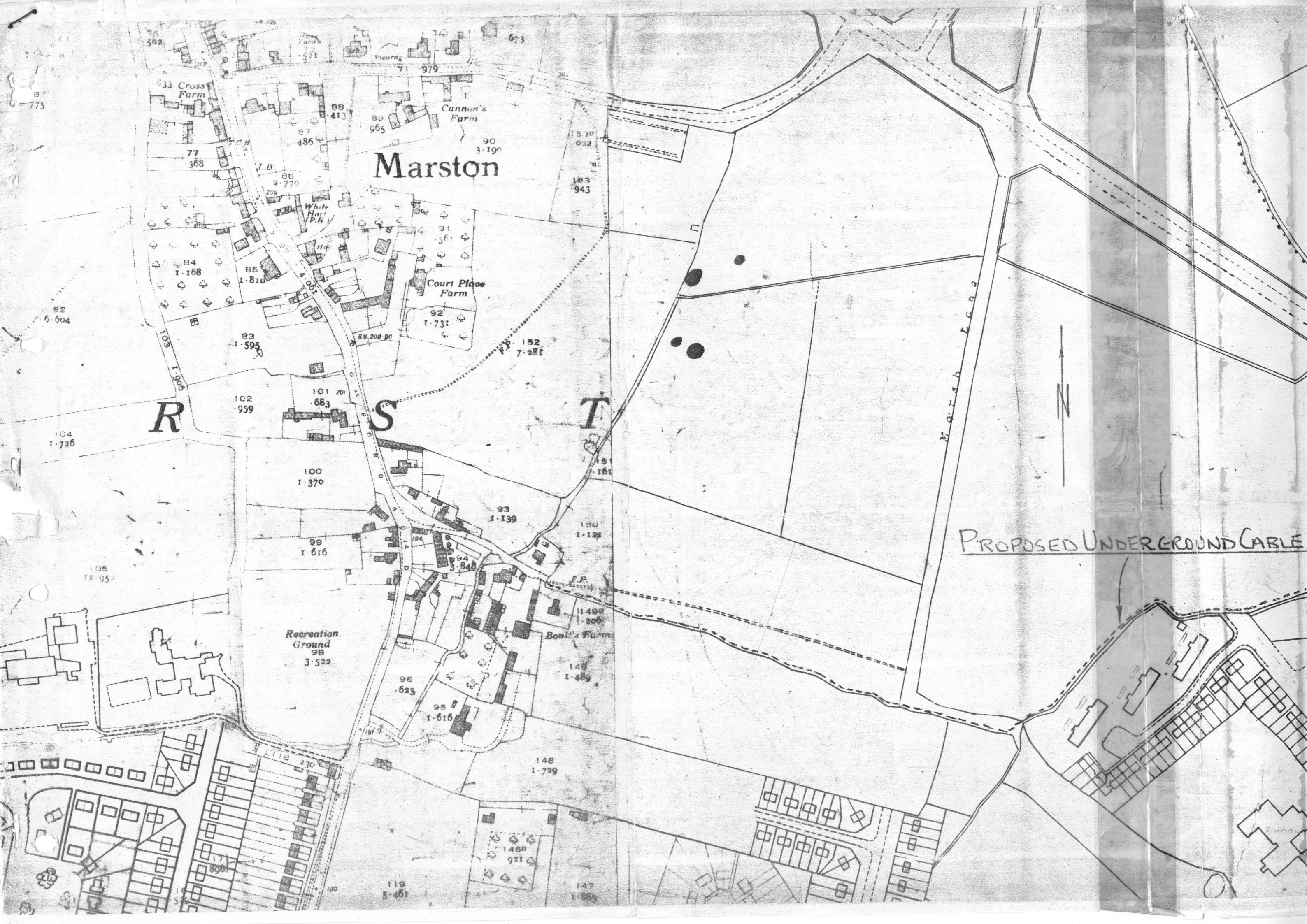

Marston

R

S

T

PROPOSED UNDERGROUND CABLE

N

833 Cross Farm

Cannon's Farm

Court Place Farm

Boni's Farm

Recreation Ground 98 3.522

175

6.604

1.726

1.952

5.461

1.883

1.460 921

1.729

1.489

1.200

1.124

1.139

1.370

1.616

1.616

1.623

1.959

1.683

1.810

1.168

368

2.770

413

965

3.190

1.943

0.22

7.281

1.731

1.595

1.906

175

6.604

1.726

1.952

5.461

1.883

1.460 921

1.729

1.489

1.200

1.124

1.139

1.370

1.616

1.616

1.623

1.959

1.683

1.810

1.168

368

2.770

413

965

3.190

1.943

0.22

7.281

1.731

1.595

1.906